



LAMINATED BREEDING EQUIPMENT SYSTEM FOR PULLET

层叠式育雏育成笼养设备

◆层叠式育雏育成笼养设备的优势：

- ④ 笼外料槽部位不会堆积粪便，可减少氨气对雏鸡生长发育的影响。
- ④ 配套合理的水线可保证雏鸡充足和卫生的饮水。
- ④ 镀锌板料槽大大延长了料槽的使用寿命，且方便清洗，能够保证饲料的清洁。
- ④ 料槽配有调节板，可满足各个生长阶段雏鸡的喂养。
- ④ 水管高度也可进行调节来适应不同生长阶段的雏鸡。
- ④ 笼网表面采用热镀锌处理技术，可保证笼网的寿命、光泽度和耐腐蚀性。

◆Advantages of pullet cage equipment:

- ④ Feed trough which is outside of the cage has no manure accumulation, which can reduce the effect of ammonia on chicken growth.
- ④ Reasonable design of water line provides enough and clean water for chicken.
- ④ Hot-dip galvanized material can extend service life of feed trough which is easy to clean to ensure the safety and health of the feed.
- ④ Feed trough with adjustable plate can meet the feeding of chicks at all stages.
- ④ Adjustable water line can also meet the drinking of chicks at all stages.
- ④ Hot-dip galvanized technology is adopted for cage mesh, which makes the cage mesh system more anticorrosive, glossy and durable.





型号① 育雏设备三维图

Model 1 3D diagram of pullet raising equipment

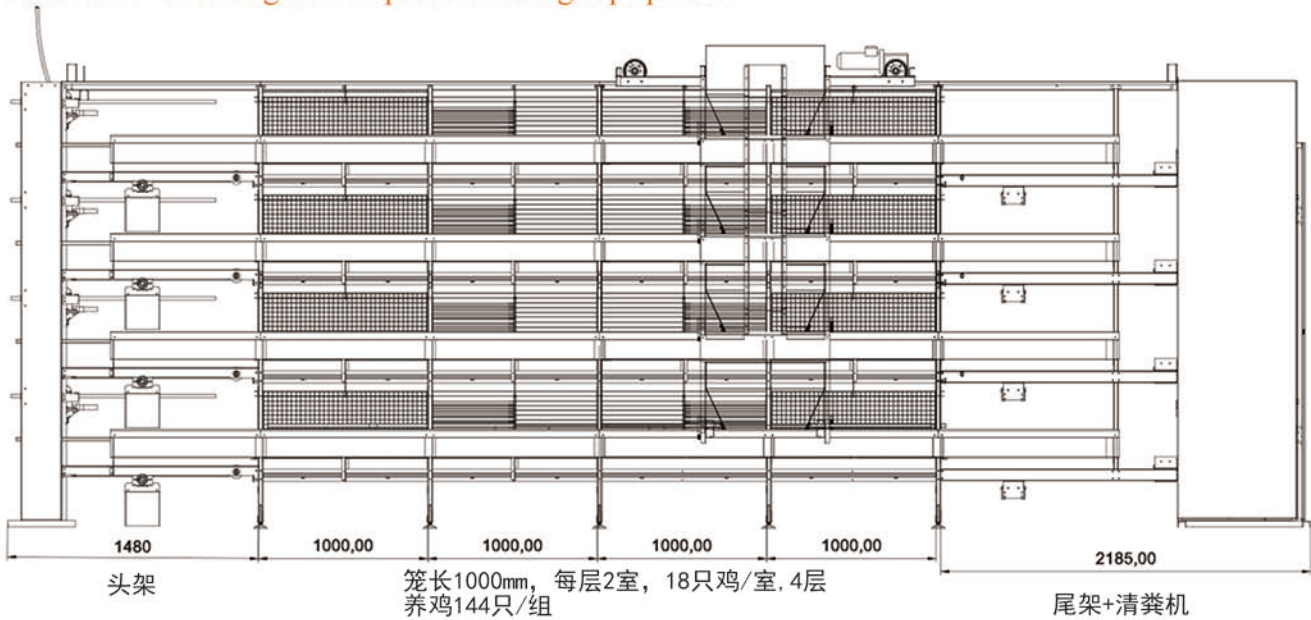

3-5层育雏笼

3/5 tiers pullet raising cage

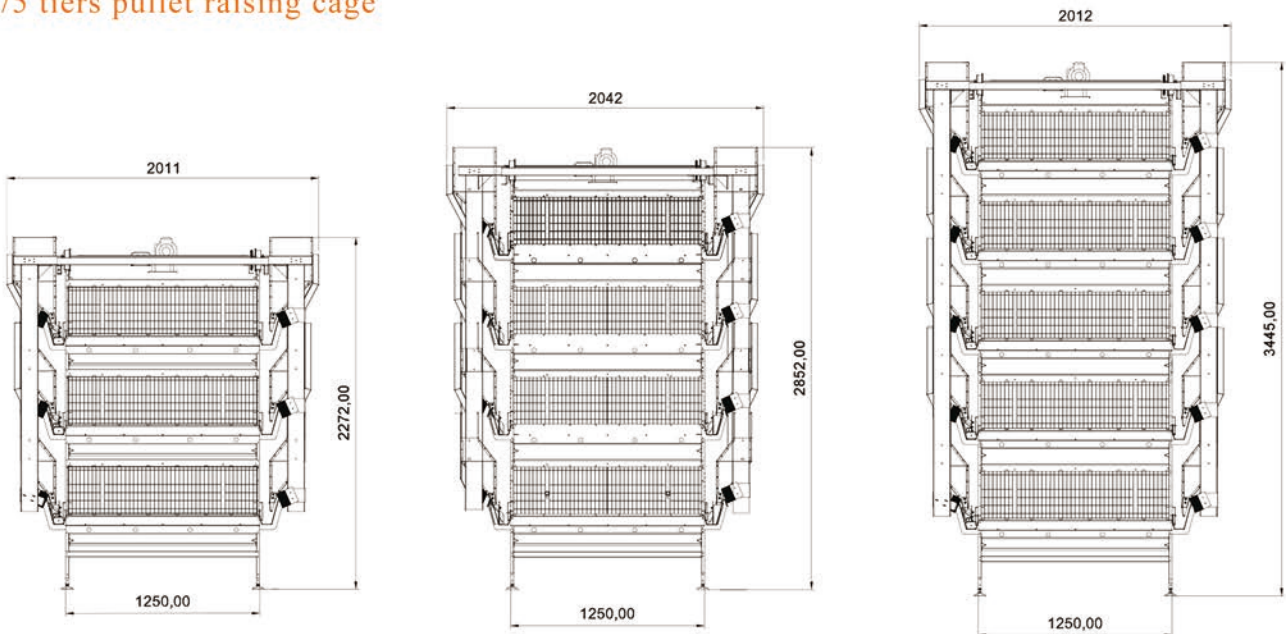

| 层数 No. of tier | 占位面积 (cm ²) average area/bird | 养殖数量 (羽/笼) birds/cage | 层距 (mm) tier distance | 笼长 (mm) cage length | 笼深 (mm) cage width | 笼高 (mm) cage height |
|-------------------|--|--------------------------|--------------------------|------------------------|-----------------------|------------------------|
| 3 | 347 | 18 | 580 | 1000 | 625 | 430 |
| 4 | 347 | 18 | 580 | 1000 | 625 | 430 |
| 5 | 347 | 18 | 580 | 1000 | 625 | 430 |

型号② Model 2



育雏设备三维图

3D diagram of pullet raising equipment

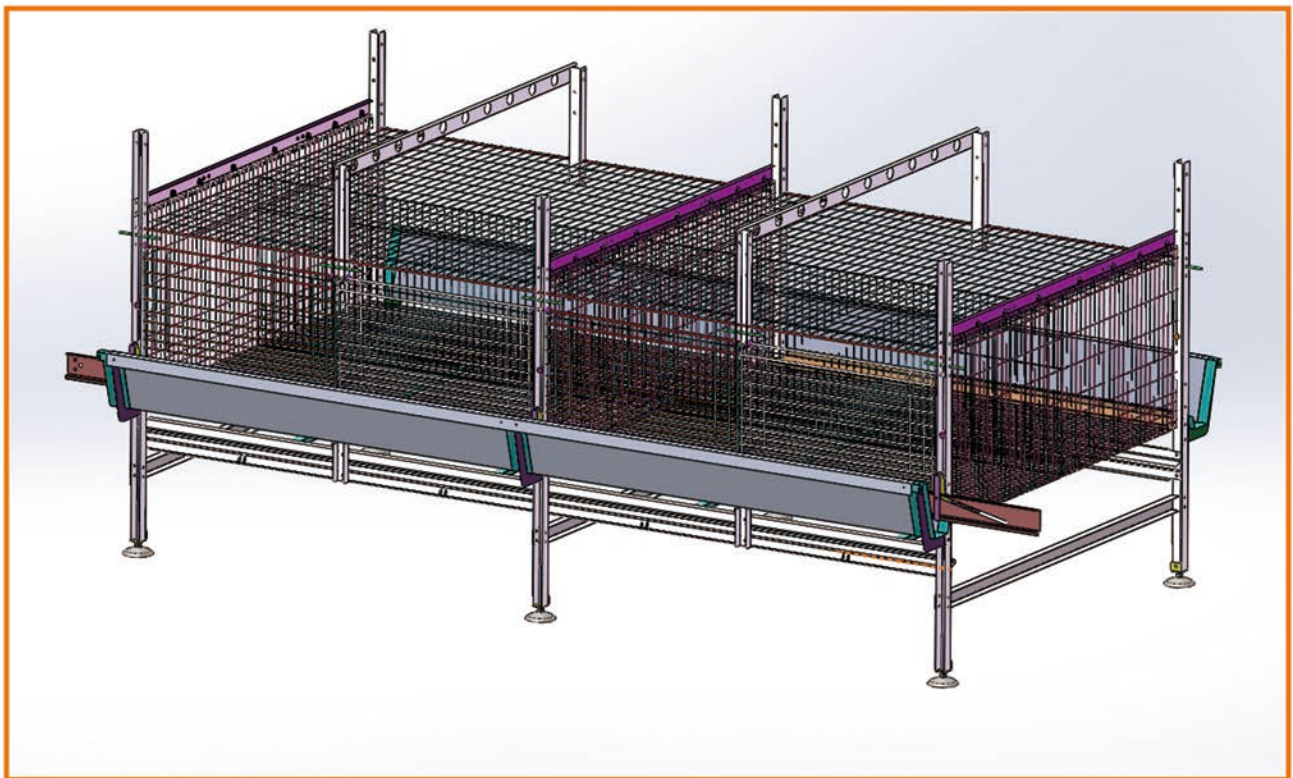

| 层数 No. of tier | 占位面积 (cm ²) average area/bird | 养殖数量 (羽/笼) birds/cage | 层距 (mm) tier distance | 笼长 (mm) cage length | 笼深 (mm) cage width | 笼高 (mm) cage height |
|-------------------|--|--------------------------|--------------------------|------------------------|-----------------------|------------------------|
| 3 | 343 | 21 | 700 | 1200 | 600 | 450 |
| 4 | 343 | 21 | 700 | 1200 | 600 | 450 |
| 5 | 343 | 21 | 700 | 1200 | 600 | 450 |